

STRIPS

ORDERING NOMENCLATURE



CONSTRUCTION

Low profile designs. Optimized for T8 or T5 lamp performance. Fixture parts snap together for ease of installation. Housings are constructed of heavy gauge roll formed steel. ETL listed for damp locations.

OPTICAL SYSTEM

Low glare, extruded acrylic refractors. Lift and shift refractors for ease of maintenance and re-lamping.

ELECTRICAL SYSTEM

Ballasts are solid-state electronic. Ballasts and lamp holders are replaceable without removing from ceiling. Discrete voltage must be specified for emergency pack options when wired with flex.

MOUNTING

Horizon wraps are provided with mounting slots within the fixture body that allow for both surface and suspended mounting applications.

FINISH

All reflective surfaces are finished with a high reflectance, lighting fixture white polyester powder. Custom finishes are available upon request.

ORDERING NOMENCLATURE

(Ex: SHALLOW ECONOMY STRIP, 2 LAMP, 32W T8, MULTI-VOLT = S232D)

SERIES	NUMBER OF LAMPS	WATTAGE	VOLTAGE	BALLAST FACTOR
S Shallow Economy Strip SA (Aluminum) For Tandem double length units, add suffix T Ex: ST	1 2 (Per Cross Section)	14 = 14W T5, 22" 17 = 17W T8, 24" 21 = 21W, T5, 34" 24 = 24W T5HO, 22" 25 = 25W, T8, 36" 28T5 = 28W T5, 46" 28T8 = 28W T8, 48" 32 = 32W T8, 48" 39 = 39W, T5HO, 34" 48HO = 60W 800mA, 48" 54 = 54W T5HO, 46"	D = Multi-Volt* 1 = 120V 2 = 277V 3 = 347V 4 = 480V (*Multi-Volt is 120/277V)	BLANK = Normal H = High L = Low



SERIES	NUMBER OF LAMPS	WATTAGE	HOUSING TYPE	VOLTAGE	BALLAST FACTOR
IS Industrial Strip ISA (Assymetrical) For Tandem double length units, add suffix T Ex: IST	1 2 (Per Cross Section)	14 = 14W T5, 22" 17 = 17W T8, 24" 21 = 21W, T5, 34" 24 = 24W T5HO, 22" 25 = 25W, T8, 36" 28T5 = 28W T5, 46" 28T8 = 28W T8, 48" 32 = 32W T8, 48" 39 = 39W, T5HO, 34" 48HO = 60W 800mA, 48" 54 = 54W T5HO, 46" 96HO = 86W T8HO, 96"	U = Uplight S = Solid	D = Multi-Volt* 1 = 120V 2 = 277V 3 = 347V 4 = 480V (*Multi-Volt is 120/277V)	BLANK = Normal H = High L = Low

SERIES	NUMBER OF LAMPS	WATTAGE	VOLTAGE	BALLAST FACTOR
KDT5 T5 Knock Down Strip For Tandem double length units, add suffix T Ex: KDT5T	1 2 3 (Per Cross Section)	14 = 14W T5, 22" 21 = 21W, T5, 34" 24 = 24W T5HO, 22" 28T5 = 28W T5, 46" 39 = 39W, T5HO, 34" 54 = 54W T5HO, 46"	D = Multi-Volt* 1 = 120V 2 = 277V 3 = 347V 4 = 480V (*Multi-Volt is 120/277V)	BLANK = Normal H = High L = Low



SERIES	NUMBER OF LAMPS	WATTAGE	VOLTAGE	BALLAST FACTOR
NKDS T8 Knock Down Strip	1	17 = 17W T8, 24" 25 = 25W T8, 40" 28T8 = 28W T8, 48" 32 = 32W T8, 48" 48HO = 60W 800mA, 48"	D = Multi-Volt* 1 = 120V 2 = 277V 3 = 347V 4 = 480V (*Multi-Volt is 120/277V)	BLANK = Normal H = High L = Low

STRIPS

SERIES	NUMBER OF LAMPS	WATTAGE	HOUSING TYPE	VOLTAGE	BALLAST FACTOR
TS Turret Strip For Tandem double length units, add suffix T Ex: TST	2 3 4 (Per Cross Section)	28T5 = 28W T5, 46" 28T8 = 28W T8, 48" 32 = 32W T8, 48" 48HO = 60W 800mA, 48" 54 = 54W T5HO, 46" 96HO = 86W T8HO, 96"	U = Uplight S = Solid	D = Multi-Volt* 1 = 120V 2 = 277V 3 = 347V 4 = 480V (*Multi-Volt is 120/277V)	BLANK = Normal H = High L = Low

SERIES	NUMBER OF LAMPS	WATTAGE	VOLTAGE	BALLAST FACTOR
1LST One Light Staggered Strip For Tandem double length units, add suffix T Ex: 1LSTT	1 (Per Cross Section)	14 = 14W T5, 22" 17 = 17W T8, 24" 21 = 21W, T5, 34" 24 = 24W T5HO, 22" 25 = 25W, T8, 36" 28T5 = 28W T5, 46" 28T8 = 28W T8, 48" 32 = 32W T8, 48" 39 = 39W, T5HO, 34" 48HO = 60W 800mA, 48" 54 = 54W T5HO, 46"	D = Multi-Volt* 1 = 120V 2 = 277V 3 = 347V 4 = 480V (*Multi-Volt is 120/277V)	BLANK = Normal H = High L = Low

SERIES	NUMBER OF LAMPS	WATTAGE	VOLTAGE	BALLAST FACTOR
2LST Two Light Staggered Strip For Tandem double length units, add suffix T Ex: 2LSTT	2 (Per Cross Section)	14 = 14W T5, 22" 17 = 17W T8, 24" 21 = 21W, T5, 34" 24 = 24W T5HO, 22" 25 = 25W, T8, 36" 28T5 = 28W T5, 46" 28T8 = 28W T8, 48" 32 = 32W T8, 48" 39 = 39W, T5HO, 34" 48HO = 60W 800mA, 48" 54 = 54W T5HO, 46"	D = Multi-Volt* 1 = 120V 2 = 277V 3 = 347V 4 = 480V (*Multi-Volt is 120/277V)	BLANK = Normal H = High L = Low

SERIES	NUMBER OF LAMPS	WATTAGE	VOLTAGE	BALLAST FACTOR
TSS Telescopic Staggered Strip	2	14 = 14W T5, 22" 17 = 17W T8, 24" 21 = 21W, T5, 34" 24 = 24W T5HO, 22" 25 = 25W, T8, 36" 28T5 = 28W T5, 46" 28T8 = 28W T8, 48" 32 = 32W T8, 48" 39 = 39W, T5HO, 34" 48HO = 60W 800mA, 48" 54 = 54W T5HO, 46"	D = Multi-Volt* 1 = 120V 2 = 277V 3 = 347V 4 = 480V (*Multi-Volt is 120/277V)	BLANK = Normal H = High L = Low

SERIES	NUMBER OF LAMPS	WATTAGE	VOLTAGE	BALLAST FACTOR
SHD Heavy Duty Strip For Tandem double length units, add suffix T Ex: SHDT	1 2 (Per Cross Section)	14 = 14W T5, 22" 17 = 17W T8, 24" 21 = 21W, T5, 34" 24 = 24W T5HO, 22" 25 = 25W, T8, 36" 28T5 = 28W T5, 46" 28T8 = 28W T8, 48" 32 = 32W T8, 48" 39 = 39W, T5HO, 34" 48HO = 60W 800mA, 48" 54 = 54W T5HO, 46"	D = Multi-Volt* 1 = 120V 2 = 277V 3 = 347V 4 = 480V (*Multi-Volt is 120/277V)	BLANK = Normal H = High L = Low

SERIES	NUMBER OF LAMPS	WATTAGE	VOLTAGE	BALLAST FACTOR
RS Recessed Strip For Tandem double length units, add suffix T Ex: RST	1 2 (Per Cross Section)	28T5 = 28W T5, 46" 28T8 = 28W T8, 48" 32 = 32W T8, 48" 48HO = 60W 800mA, 48" 54 = 54W T5HO, 46" 96HO = 86W T8HO, 96"	D = Multi-Volt* 1 = 120V 2 = 277V 3 = 347V 4 = 480V (*Multi-Volt is 120/277V)	BLANK = Normal H = High L = Low

S SERIES

Shallow Economy Strip

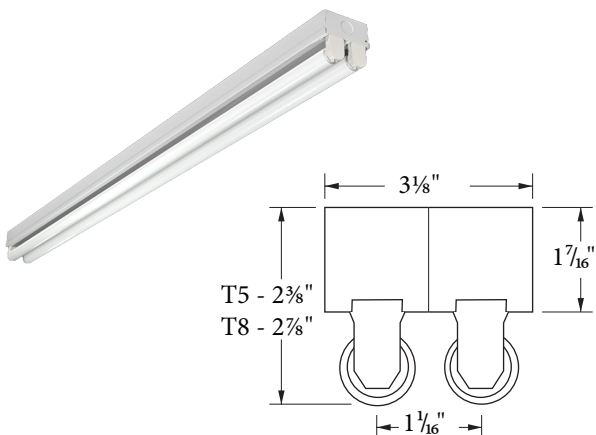

DESIGN

The S Series Shallow Economy Strip is designed for general purpose applications. It is an excellent choice for commercial, industrial, or retail applications such as storage/utility areas, shops, task and general lighting.

ACCESSORIES

Order as separate line item

6' 16/3 CORD W/ 15A NEMA PLUG
 C1 (120V)
 C2 (277V)
 C4 (480V)

T8 EMERGENCY BALLAST
 EB5 (500 LUMEN)
 EB7 (700 LUMEN)
 EB14 (1400 LUMEN)
 EB30 (3000 LUMEN)

MOTION SENSOR
 WOC (120/277V)
 WOC1 (347/480V)

WIRE GUARD
 SWG2 (2')
 SWG3 (3')
 SWG4 (4')

ASYMMETRICAL REFLECTOR
 AR2 (2')
 AR3 (3')
 AR4 (4')

WIRING HARNESS
 WH34 (3 WIRE, 4')
 WH44 (4 WIRE, 4')
 WH54 (5 WIRE, 4')

PHOTOMETRICS

IES INDOOR REPORT
 PHOTOMETRIC FILENAME: S132.IES
 POLAR GRAPH

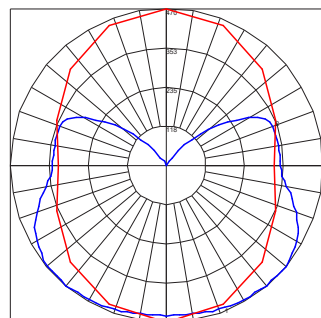

Maximum Candela = 470. Located At Horizontal Angle = 90, Vertical Angle = 40
 # 1 - Vertical Plane Through Horizontal Angles (90 - 270) Through Max. Cd.
 # 2 - Horizontal Cone Through Vertical Angle (40) Through Max. Cd.

IES INDOOR REPORT
 PHOTOMETRIC FILENAME: S232.IES
 POLAR GRAPH

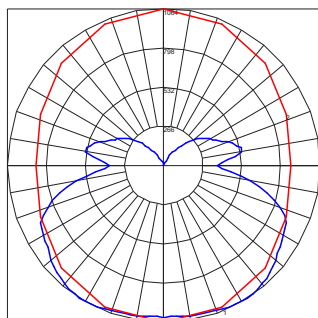

Maximum Candela = 1064. Located At Horizontal Angle = 90, Vertical Angle = 30
 # 1 - Vertical Plane Through Horizontal Angles (90 - 270) Through Max. Cd.
 # 2 - Horizontal Cone Through Vertical Angle (30) Through Max. Cd.

ORDERING INFORMATION

Description	Part Number
1L 17W T8 120/277V	S117D (A)
1L 25W T8 120/277V	S125D (A)
1L 32W T8 120/277V	S132D (A)
1L 54W T5HO 120/277V	S154D (A)
2L 17W T8 120/277V	S217D (A)
2L 25W T8 120/277V	S225D (A)
2L 32W T8 120/277V	S232D (A)
2L 54W T5HO 120/277V	S254D (A)

Option Codes

- (A) Options
 Blank - None
 10RS - ≤10% THD, Rapid Start
 P - Program Start
 20 - ≤20% THD

MOUNTING

2 Sets of each mount must be ordered per fixture

 (3)S HOOKS AND CHAIN SET
 10JC

 TONG HANGER
 THE (END MOUNT)
 THS (SIDE MOUNT)

 AIRCRAFT CABLE WITH 12" ARMS
 G10 (10')
 G12 (12')
 G15 (15')

TECHNICAL INFORMATION

Fixture housing, lamp holder brackets, end sections, and channel cover are constructed of heavy gauge die-formed steel¹. ETL listed. Suitable for damp locations. Ballasts are solid state electronic. Ballasts and lamp holders are replaceable without removing from ceiling. Can be mounted as single fixture or in a continuous row. All reflective surfaces are finished with a high reflectance, lighting fixture white polyester powder.

Notes: 1-Aluminum body version is available. See Strips Complete Nomenclature page for ordering information.

IS SERIES

Industrial Strip

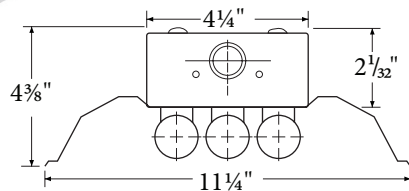

ORDERING INFORMATION

Description	Part Number ¹
1L 17W T8 120/277V	IS117 (A)D(B)
1L 25W T8 120/277V	IS125 (A)D(B)
1L 32W T8 120/277V	IS132 (A)D(B)
1L 54W T5HO 120/277V	IS154 (A)D(B)
2L 17W T8 120/277V	IS217 (A)D(B)
2L 25W T8 120/277V	IS225 (A)D(B)
2L 32W T8 120/277V	IS232 (A)D(B)
2L 54W T5HO 120/277V	IS254 (A)D(B)

Option Codes

(A) Housing
 U - Uplight
 S - Solid

(B) Options
 Blank - None
 10RS - ≤10% THD, Rapid Start
 P - Program Start
 20 - ≤20% THD

DESIGN

The IS Series Industrial Strip is designed as a high quality general purpose fixture with a symmetrical reflector¹. It is ideal for simple task and area lighting applications and industrial environments.

MOUNTING

2 Sets of each mount must be ordered per fixture



(3)S HOOKS AND CHAIN SET
10JC



TONG HANGER THE (END MOUNT) THS (SIDE MOUNT)



AIRCRAFT CABLE WITH 12" ARMS
 G10 (10')
 G12 (12')
 G15 (15')

ACCESSORIES

Order as separate line item



6' 16/3 CORD W/ 15A NEMA PLUG
 C1 (120V)
 C2 (277V)
 C4 (480V)



WIRE GUARD ISWG4 (4')



T8 EMERGENCY BALLAST
 EB5 (500 LUMEN)
 EB7 (700 LUMEN)
 EB14 (1400 LUMEN)
 EB30 (3000 LUMEN)



WIRING HARNESS
 WH34 (3 WIRE, 4')
 WH44 (4 WIRE, 4')
 WH54 (5 WIRE, 4')



MOTION SENSOR
 WOC (120/277V)
 WOC1 (347/480V)



ALIGNER CLIP HLFACLIP

PHOTOMETRICS

IES INDOOR REPORT
 PHOTOMETRIC FILENAME : IS232.IES

POLAR GRAPH

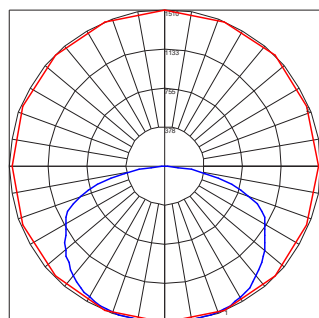

Maximum Candela = 1910, Located At Horizontal Angle = 90, Vertical Angle = 7.5
 # 1 - Vertical Plane Through Horizontal Angles (90 - 270) (Through Max. Cd.)
 # 2 - Horizontal Plane Through Vertical Angle (7.5) (Through Max. Cd.)

TECHNICAL INFORMATION

Fixture housing, lamp holder brackets, end sections, and channel cover are constructed of heavy gauge die-formed steel. Sturdy embossed reflectors effectively direct and control light. ETL listed. Suitable for damp locations. Ballasts are solid state electronic. Ballasts and lamp holders are replaceable without removing from ceiling. Can be mounted as single fixture or in a continuous row. All reflective surfaces are finished with a high reflectance, lighting fixture white polyester powder.

Notes: 1-Asymmetrical Reflector version is available. See Strips Complete Nomenclature page for ordering information.

KDT5 SERIES

T5 Low-Profile Knock Down Strip

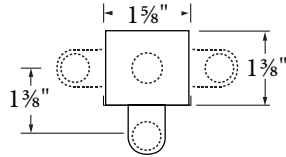

DESIGN

The KDT5 Low-Profile Knock Down Strip is designed as a high quality, efficient T5 strip light. It can be used in a number of general lighting applications such as in shallow coves, showcases, displays, and used for task lighting.

ACCESSORIES

Order as separate line item

6' 16/3 CORD W/ 15A NEMA PLUG
C1 (120V)
C2 (277V)
C4 (480V)

WIRING HARNESS
WH34 (3 WIRE, 4')
WH44 (4 WIRE, 4')
WH54 (5 WIRE, 4')

T8 EMERGENCY BALLAST
EB5 (500 LUMEN)
EB7 (700 LUMEN)
EB14 (1400 LUMEN)
EB30 (3000 LUMEN)

MOTION SENSOR
WOC (120/277V)
WOC1 (347/480V)

ORDERING INFORMATION

Description	Part Number ¹
1L 14W T5 120/277V	KDT511424D (A)
1L 21W T5 120/277V	KDT512136D (A)
1L 24W T5HO 120/277V	KDT512424D (A)
1L 28W T5 120/277V	KDT512848D (A)
1L 39W T5HO 120/277V	KDT513936D (A)
1L 54W T5HO 120/277V	KDT515448D (A)
2L 14W T5 120/277V	KDT521424D (A)
2L 21W T5 120/277V	KDT522136D (A)
2L 24W T5HO 120/277V	KDT522424D (A)
2L 28W T5 120/277V	KDT522848D (A)
2L 39W T5HO 120/277V	KDT523936D (A)
2L 54W T5HO 120/277V	KDT525448D (A)

Option Codes

(A) Options

Blank - None
10RS - ≤10% THD, Rapid Start
P - Program Start
20 - ≤20% THD

MOUNTING

2 Sets of each mount must be ordered per fixture



(3)S HOOKS AND
CHAIN SET
10JC



TONG HANGER
THE (END MOUNT)
THS (SIDE MOUNT)



AIRCRAFT CABLE WITH
12" ARMS
G10 (10')
G12 (12')
G15 (15')

TECHNICAL INFORMATION

Fixture housing, lamp holder brackets, end sections, and channel cover are constructed of heavy gauge die-formed steel. ETL listed. Suitable for damp locations. Ballasts are T5 solid state electronic. Ballasts and lamp holders are replaceable without removing from ceiling. Can be mounted as single fixture or in a continuous row. All reflective surfaces are finished with a high reflectance, lighting fixture white polyester powder.

NKDS SERIES

T8 Low-Profile Knock Down Strip

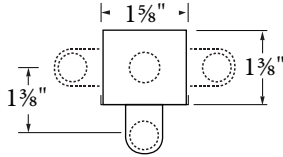

DESIGN

The NKDS Low-Profile Knock Down Strip is designed as a high quality, efficient T8 strip light. It can be used in a number of general lighting applications such as in shallow coves, showcases, displays, and used for task lighting.

ACCESSORIES

Order as separate line item



6' 16/3 CORD W/ 15A
NEMA PLUG
C1 (120V)
C2 (277V)
C4 (480V)



WIRING HARNESS
WH34 (3 WIRE, 4')
WH44 (4 WIRE, 4')
WH54 (5 WIRE, 4')



T8 EMERGENCY BALLAST
EB5 (500 LUMEN)
EB7 (700 LUMEN)
EB14 (1400 LUMEN)
EB30 (3000 LUMEN)



MOTION SENSOR
WOC (120/277V)
WOC1 (347/480V)

PHOTOMETRICS

IES INDOOR REPORT
PHOTOMETRIC FILENAME : NKDS132.IES
POLAR GRAPH

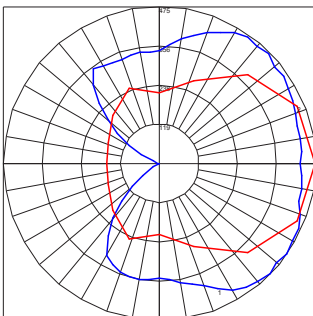

Maximum Candela = 475 Located At Horizontal Angle = 0, Vertical Angle = 45
1 - Vertical Plane Through Horizontal Angles (0 - 180) (Through Max. Cd.)
2 - Horizontal Plane Through Vertical Angle (45) (Through Max. Cd.)

ORDERING INFORMATION

Description	Part Number
1L 17W T8 120/277V	NKDS1172D (A)
1L 25W T8 120/277V	NKDS1253D (A)
1L 28W T8 120/277V	NKDS128T84D (A)
1L 32W T8 120/277V	NKDS1324D (A)

Option Codes

(A) Options
Blank - None
10RS - ≤10% THD, Rapid Start
P - Program Start
20 - ≤20% THD

MOUNTING

2 Sets of each mount must be ordered per fixture



(3)S HOOKS AND
CHAIN SET
10JC



TONG HANGER
THE (END MOUNT)
THS (SIDE MOUNT)



AIRCRAFT CABLE WITH
12" ARMS
G10 (10')
G12 (12')
G15 (15')

TECHNICAL INFORMATION

Fixture housing, lamp holder brackets, end sections, and channel cover are constructed of heavy gauge die-formed steel. ETL listed. Suitable for damp locations. Ballasts are T8 solid state electronic. Ballasts and lamp holders are replaceable without removing from ceiling. Can be mounted as single fixture or in a continuous row. All reflective surfaces are finished with a high reflectance, lighting fixture white polyester powder.

TS SERIES

Turret Strip

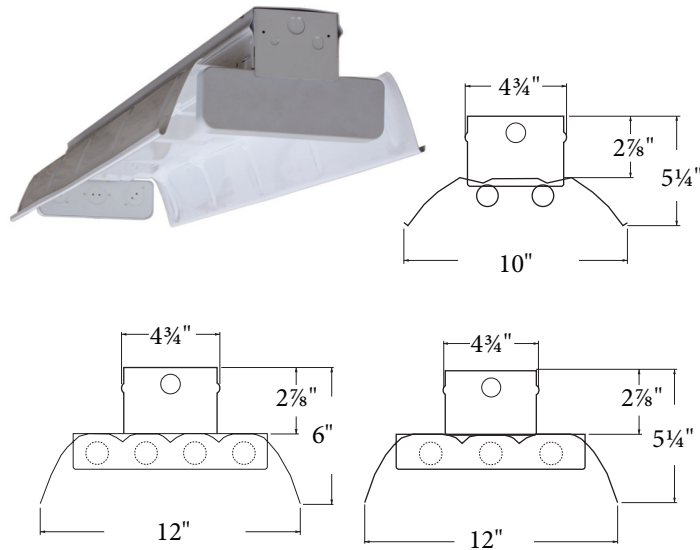

DESIGN

The TS Series Turret Strip is designed as a high quality general purpose fixture with a symmetrical reflector. It is ideal for simple task and area lighting applications and industrial environments where vibration is an issue so lamps will remain secured in the fixture.

ACCESSORIES

Order as separate line item

6' 16/3 CORD W/ 15A NEMA PLUG
 C1 (120V)
 C2 (277V)
 C4 (480V)

WIRING HARNESS
 WH34 (3 WIRE, 4')
 WH44 (4 WIRE, 4')
 WH54 (5 WIRE, 4')

T8 EMERGENCY BALLAST
 EB5 (500 LUMEN)
 EB7 (700 LUMEN)
 EB14 (1400 LUMEN)
 EB30 (3000 LUMEN)

MOTION SENSOR
 WOC (120/277V)
 WOC1 (347/480V)

PHOTOMETRICS

IES INDOOR REPORT
 PHOTOMETRIC FILENAME : T5232.IES

POLAR GRAPH

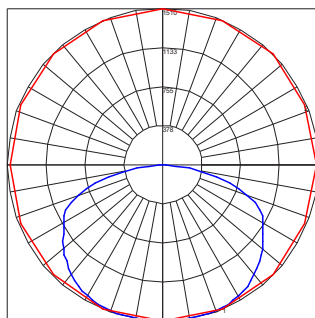

Maximum Candela = 1510 Located At Horizontal Angle = 90, Vertical Angle = 7.5
 # 1 - Vertical Plane Through Horizontal Angles (0 - 270) (Through Max. Cd.)
 # 2 - Horizontal Cone Through Vertical Angle (7.5) (Through Max. Cd.)

1.800.225.0727

ORDERING INFORMATION

Description	Part Number
2L 32W T8 120/277	TS232 (A)D(B)
2L 28W TT 120/277	TS228T5 (A)D(B)
2L 54W T5HO 120/277	TS254 (A)D(B)
3L 32W T8 120/277	TS332 (A)D(B)
3L 28W T5 120/277	TS328T5 (A)D(B)
3L 54W T5HO 120/277	TS354 (A)D(B)
4L 32W T8 120/277	TS432 (A)D(B)
4L 28W T5 120/277	TS428T5 (A)D(B)
4L 54W T5HO 120/277	TS454 (A)D(B)

Option Codes

(A) Housing
 U - Uplight
 S - Solid

(B) Options
 Blank - None
 10RS - ≤10% THD, Rapid Start
 P - Program Start
 20 - ≤20% THD
 IO - Inboard/Outboard (2 Lamp-2 Lamp)
 IO2 - Inboard/Outboard (1 Lamp-3 Lamp)

MOUNTING

2 Sets of each mount must be ordered per fixture



(3)S HOOKS AND CHAIN SET
 10JC



TONG HANGER
 THE (END MOUNT)
 THS (SIDE MOUNT)



AIRCRAFT CABLE WITH 12" ARMS
 G10 (10')
 G12 (12')
 G15 (15')

TECHNICAL INFORMATION

Fixture housing and channel cover are constructed of heavy gauge die-formed steel. Sockets enclosed in turret-type housing. Sturdy embossed reflectors effectively direct and control light. ETL listed. Suitable for damp locations. Ballasts are solid state electronic. Ballasts and lamp holders are replaceable without removing from ceiling. Can be mounted as single fixture or in a continuous row. All reflective surfaces are finished with a high reflectance, lighting fixture white polyester powder.

WWW.TECLIGHTUSA.COM

All specifications are subject to change without notice. Please refer to www.techlightusa.com for the most current information.

3 | 1

STRIPS

1LST SERIES

One Lamp Staggered Strip

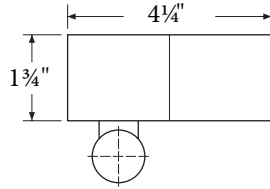

All Dimensions are subject to change without notice

DESIGN

The 1LST Series One Lamp Staggered Strip is designed to maintain a uniform distribution of light and eliminate dark spots between lamps. It was made specifically for coves or display cases where lighting is installed as a continuous run from end to end.

ORDERING INFORMATION

Description	Part Number
1L 14W T5 120/277V	1LST11424D (A)
1L 17W T8 120/277V	1LST11724D (A)
1L 21W T5 120/277V	1LST12136D (A)
1L 24W T5HO 120/277V	1LST12424D (A)
1L 25W T8 120/277V	1LST12536D (A)
1L 28W T5 120/277V	1LST128T524D (A)
1L 32W T8 120/277V	1LST13248D (A)
1L 39W T5HO 120/277V	1LST13936D (A)
1L 54W T5HO 120/277V	1LST15448D (A)

Option Codes

- (A) Options
 Blank - None
 10RS - ≤10% THD, Rapid Start
 P - Program Start
 20 - ≤20% THD

MOUNTING

2 Sets of each mount must be ordered per fixture



- (3)S HOOKS AND CHAIN SET
- 10JC



- AIRCRAFT CABLE WITH 12" ARMS
- G10 (10')
- G12 (12')
- G15 (15')

STRIPS

ACCESSORIES

Order as separate line item



- 6' 16/3 CORD W/ 15A NEMA PLUG
- C1 (120V)
- C2 (277V)
- C4 (480V)

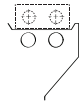

- ASSYMETRICAL REFLECTOR
- AR2 (2')
- AR3 (3')
- AR4 (4')



- T8 EMERGENCY BALLAST
- EB5 (500 LUMEN)
- EB7 (700 LUMEN)
- EB14 (1400 LUMEN)
- EB30 (3000 LUMEN)



- WIRING HARNESS
- WH34 (3 WIRE, 4')
- WH44 (4 WIRE, 4')
- WH54 (5 WIRE, 4')

PHOTOMETRICS

IES INDOOR REPORT
 PHOTOMETRIC FILENAME : 1LST132.IES
 POLAR GRAPH

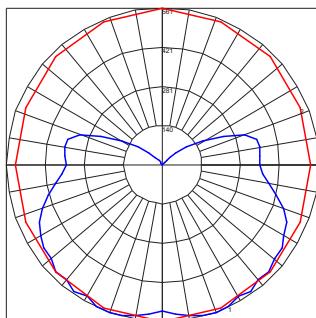

Maximum Candela = 561 Located At Horizontal Angle = 90, Vertical Angle = 15
 # 1 - Vertical Plane Through Horizontal Angles (90 - 270) (Through Max. Cd.)
 # 2 - Horizontal Plane Through Vertical Angle (15) (Through Max. Cd.)

TECHNICAL INFORMATION

Fixture housing, lamp holder brackets, end sections, and channel cover are constructed of heavy gauge die-formed steel. ETL listed. Suitable for damp locations. Ballasts are solid state electronic. Ballasts and lamp holders are replaceable without removing from ceiling. Can be mounted as single fixture or in a continuous row. All reflective surfaces are finished with a high reflectance, lighting fixture white polyester powder.

2LST SERIES

Two Lamp Staggered Strip

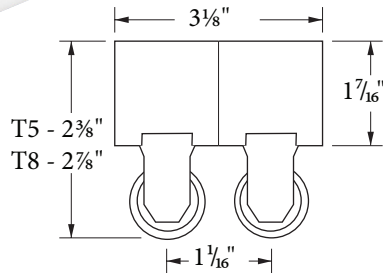

DESIGN

The 2LST Series Two Lamp Staggered Strip is designed to maintain a uniform distribution of light and eliminate dark spots between lamps. It was made specifically for coves or display cases where lighting is installed as a continuous run from end to end.

ACCESSORIES

Order as separate line item



6' 16/3 CORD W/ 15A NEMA PLUG
 C1 (120V)
 C2 (277V)
 C4 (480V)

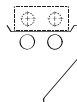

ASSYMETRICAL REFLECTOR
 AR2 (2')
 AR3 (3')
 AR4 (4')



T8 EMERGENCY BALLAST
 EB5 (500 LUMEN)
 EB7 (700 LUMEN)
 EB14 (1400 LUMEN)
 EB30 (3000 LUMEN)



WIRING HARNESS
 WH34 (3 WIRE, 4')
 WH44 (4 WIRE, 4')
 WH54 (5 WIRE, 4')

PHOTOMETRICS

IES INDOOR REPORT
 PHOTOMETRIC FILENAME : 2LST232.IES

POLAR GRAPH

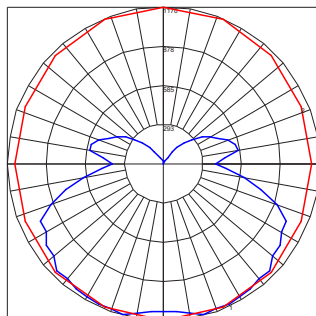

Maximum Candela = 1170 Located At Horizontal Angle = 90, Vertical Angle = 15
 # 1 - Vertical Plane Through Horizontal Angles (90 - 270) (Through Max. Cd.)
 # 2 - Horizontal Cone Through Vertical Angle (15) (Through Max. Cd.)

ORDERING INFORMATION

Description	Part Number
2L 14W T5 120/277V	2LST21424D (A)
2L 17W T8 120/277V	2LST21724D (A)
2L 21W T5 120/277V	2LST22136D (A)
2L 24W T5HO 120/277V	2LST22424D (A)
2L 25W T8 120/277V	2LST22536D (A)
2L 28W T5 120/277V	2LST228T524D (A)
2L 32W T8 120/277V	2LST23248D (A)
2L 39W T5HO 120/277V	2LST23936D (A)
2L 54W T5HO 120/277V	2LST25448D (A)

Option Codes

(A) Options

Blank - None
 10RS - ≤10% THD, Rapid Start
 P - Program Start
 20 - ≤20% THD

MOUNTING

2 Sets of each mount must be ordered per fixture



(3)S HOOKS AND 36" CHAIN SET
 10JC



AIRCRAFT CABLE WITH 12" ARMS
 G10 (10')
 G12 (12')
 G15 (15')

TECHNICAL INFORMATION

Fixture housing, lamp holder brackets, end sections, and channel cover are constructed of heavy gauge die-formed steel. ETL listed. Suitable for damp locations. Ballasts are solid state electronic. Ballasts and lamp holders are replaceable without removing from ceiling. Can be mounted as single fixture or in a continuous row. All reflective surfaces are finished with a high reflectance, lighting fixture white polyester powder.

TSS SERIES

Telescopic Staggered Strip

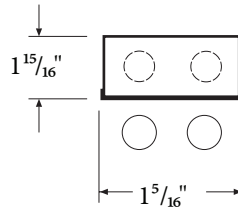

DESIGN

The TSS Series Telescopic Staggered Strip is adjustable to maintain a uniform distribution of light especially helpful in end of row applications. The fixture was designed specifically for coves or display cases where lighting is installed as a continuous run from end to end.

ACCESSORIES

Order as separate line item



6' 16/3 CORD W/ 15A
NEMA PLUG
C1 (120V)
C2 (277V)
C4 (480V)



WIRING HARNESS
WH34 (3 WIRE, 4')
WH44 (4 WIRE, 4')
WH54 (5 WIRE, 4')



T8 EMERGENCY BALLAST
EB5 (500 LUMEN)
EB7 (700 LUMEN)
EB14 (1400 LUMEN)
EB30 (3000 LUMEN)



MOTION SENSOR
WOC (120/277V)
WOC1 (347/480V)

PHOTOMETRICS

IES INDOOR REPORT
PHOTOMETRIC FILENAME: TSS232.IES
POLAR GRAPH

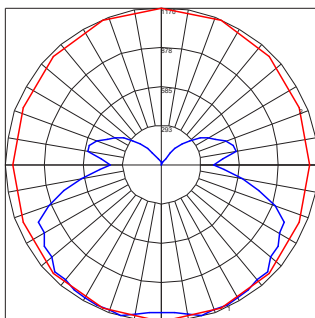

Maximum Candela = 1170 Located At Horizontal Angle = 90, Vertical Angle = 15
1 - Vertical Plane Through Horizontal Angles (0 - 270) (Through Max. Cd.)
2 - Horizontal Plane Through Vertical Angle (15) (Through Max. Cd.)

ORDERING INFORMATION

Description	Part Number
2L 14W T5 120/277V	TSS214D(A)
2L 17W T8 120/277V	TSS217D(A)
2L 21W T8 120/277V	TSS221D(A)
2L 24W T5HO 120/277V	TSS224D(A)
2L 25W T8 120/277V	TSS225D(A)
2L 28W T5 120/277V	TSS228T5D(A)
2L 32W T8 120/277V	TSS232D(A)
2L 39W T5HO 120/277V	TSS239D(A)
2L 54W T5HO 120/277V	TSS254D(A)

Option Codes

(A) Options

Blank - None
10RS - ≤10% THD, Rapid Start
P - Program Start
20 - ≤20% THD

MOUNTING

2 Sets of each mount must be ordered per fixture



(3)S HOOKS AND
CHAIN SET
10JC



TONG HANGER
THE (END MOUNT)
THS (SIDE MOUNT)



AIRCRAFT CABLE WITH
12" ARMS
G10 (10')
G12 (12')
G15 (15')

TECHNICAL INFORMATION

Fixture housing, lamp holder brackets, end sections, and channel cover are constructed of heavy gauge die-formed steel. Fully open, fixture stagger is as follows: 2' = 10", 3' = 20", 4' = 26". ETL listed. Suitable for damp locations. Ballasts are solid state electronic. Ballasts and lamp holders are replaceable without removing from ceiling. Can be mounted as single fixture or in a continuous row. All reflective surfaces are finished with a high reflectance, lighting fixture white polyester powder.

SHD SERIES

Heavy Duty Strip

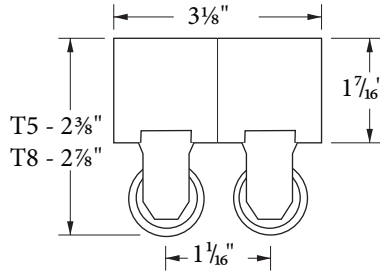
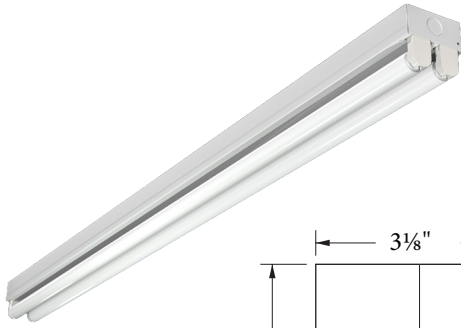

DESIGN

The SHD Series Heavy Duty Strip is designed for general purpose applications in harsh environments. It is an excellent choice for commercial, industrial, or retail applications such as storage/utility areas, shops, task and general lighting.

ACCESSORIES

Order as separate line item



6' 16/3 CORD W/ 15A NEMA PLUG
C1 (120V)
C2 (277V)
C4 (480V)



T8 EMERGENCY BALLAST
EB5 (500 LUMEN)
EB7 (700 LUMEN)
EB14 (1400 LUMEN)
EB30 (3000 LUMEN)



MOTION SENSOR
WOC (120/277V)
WOC1 (347/480V)



WIRE GUARD
SWG2 (2')
SWG3 (3')
SWG4 (4')

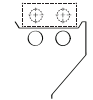

ASYMMETRICAL REFLECTOR
AR2 (2')
AR3 (3')
AR4 (4')



WIRING HARNESS
WH34 (3 WIRE, 4')
WH44 (4 WIRE, 4')
WH54 (5 WIRE, 4')

PHOTOMETRICS

IES INDOOR REPORT
PHOTOMETRIC FILENAME : SHD132.IES
POLAR GRAPH

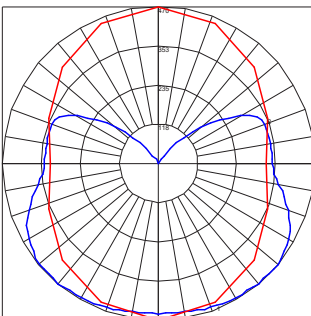

Maximum Candela = 470. Located At Horizontal Angle = 90, Vertical Angle = 40
1 - Vertical Plane Through Horizontal Angles (90 - 270) (Through Max. Cd.)
2 - Horizontal Plane Through Vertical Angle (40) (Through Max. Cd.)

IES INDOOR REPORT
PHOTOMETRIC FILENAME : SHD232.IES
POLAR GRAPH

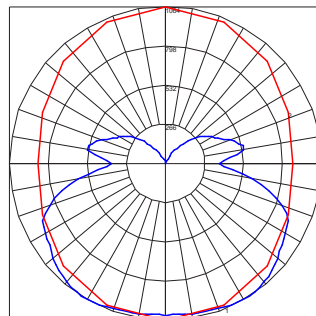

Maximum Candela = 1064. Located At Horizontal Angle = 90, Vertical Angle = 30
1 - Vertical Plane Through Horizontal Angles (90 - 270) (Through Max. Cd.)
2 - Horizontal Plane Through Vertical Angle (30) (Through Max. Cd.)

ORDERING INFORMATION

Description ¹	Part Number
1L 17W T8 120/277V	SHD117D (A)
1L 25W T8 120/277V	SHD125D (A)
1L 32W T8 120/277V	SHD132D (A)
1L 54W T5HO 120/277V	SHD154D (A)
2L 17W T8 120/277V	SHD217D (A)
2L 25W T8 120/277V	SHD225D (A)
2L 32W T8 120/277V	SHD232D (A)
2L 54W T5HO 120/277V	SHD254D (A)

Option Codes

(A) Options

Blank - None
10RS - ≤10% THD, Rapid Start
P - Program Start
20 - ≤20% THD

MOUNTING

2 Sets of each mount must be ordered per fixture



(3)S HOOKS AND CHAIN SET
10JC



TONG HANGER
THE (END MOUNT)
THS (SIDE MOUNT)



AIRCRAFT CABLE WITH 12" ARMS
G10 (10')
G12 (12')
G15 (15')

TECHNICAL INFORMATION

Fixture housing, lamp holder brackets, end sections, and channel cover are constructed of heavy gauge die-formed steel¹. ETL listed. Suitable for damp locations. Ballasts are solid state electronic. Ballasts and lamp holders are replaceable without removing from ceiling. Can be mounted as single fixture or in a continuous row. All reflective surfaces are finished with a high reflectance, lighting fixture white polyester powder.

RS SERIES

Recessed Strip

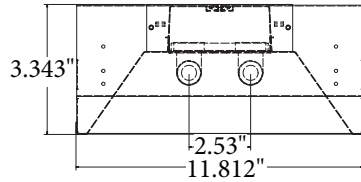
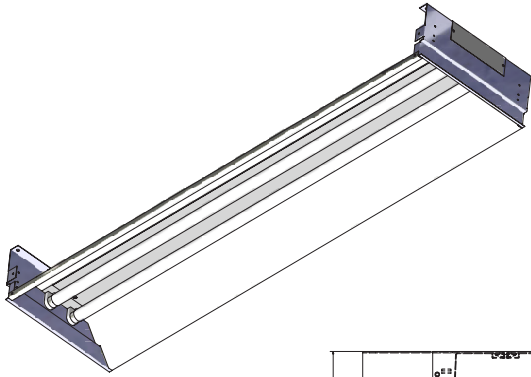

DESIGN

The RS Series Recessed Strip is designed for general purpose applications. It is an excellent choice for commercial, industrial, or retail applications such as storage/utility areas, shops, task and general lighting where a recessed light fixture is required.

ORDERING INFORMATION

Description	Part Number
2L 28W T8 120/277V	RS228T8D(A)
2L 28W T5 120/277V	RS228T5D(A)
2L 32W T8 120/277V	RS232D(A)
2L 54W T5 120/277V	RS254D(A)
2L 86W T8HO 120/277V	RS296HOD(A)
2L TANDEM 28W T8 120/277V	RST228T8D(A)
2L TANDEM ¹ 28W T5 120/277V	RST228T5D(A)
2L TANDEM ¹ 32W T8 120/277V	RST232D(A)
2L TANDEM ¹ 54W T5HO 120/277V	RST254D(A)

STRIPS

ACCESSORIES

Order as separate line item

 6' 16/3 CORD W/ 15A NEMA PLUG
C1 (120V)
C2 (277V)
C4 (480V)

 WIRE GUARD
SWG2 (2')
SWG3 (3')
SWG4 (4')

 T8 EMERGENCY BALLAST
EB5 (500 LUMEN)
EB7 (700 LUMEN)
EB14 (1400 LUMEN)
EB30 (3000 LUMEN)

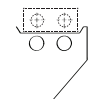
 ASSYMETRICAL REFLECTOR
AR2 (2')
AR3 (3')
AR4 (4')

 MOTION SENSOR
WOC (120/277V)
WOC1 (347/480V)

 WIRING HARNESS
WH34 (3 WIRE, 4')
WH44 (4 WIRE, 4')
WH54 (5 WIRE, 4')

PHOTOMETRICS

IES INDOOR REPORT
PHOTOMETRIC FILENAME: RS232.IES
POLAR GRAPH

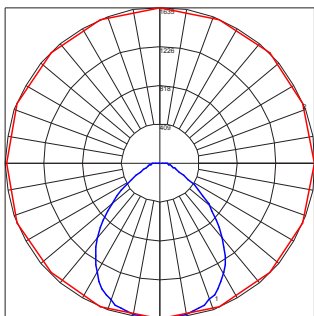

Maximum Candela = 1635 Located At Horizontal Angle = 45, Vertical Angle = 2.5
1 - Vertical Plane Through Horizontal Angles (45 - 225) (Through Max. Cd.)
2 - Horizontal Plane Through Vertical Angle (2.5) (Through Max. Cd.)

TECHNICAL INFORMATION

Fixture housing, lamp holder brackets, end sections, and channel cover are constructed of heavy gauge die-formed steel. Designed for installation into 1' x 4' and 1' x 8' T-grid ceilings. ETL listed. Suitable for damp locations. Ballasts are solid state electronic. Ballasts and lamp holders are replaceable without removing from ceiling. All reflective surfaces are finished with a high reflectance, lighting fixture white polyester powder.

Notes: 1-The number of lamps referred to in the description is the number of lamps per cross section. There are two cross sections in a tandem fixture.